

XIV Configuration list

NO.	Name	Specification	Quantity	Remark
1	Lamp head	LED-80W	1	
2	Spring arm	—	1	
3	Center column	Φ45x820mm	1	
4	Ceiling plate	Φ198x8mm	1	
5	Decorative cover	Φ255x90mm	1	
6	Central handle	—	1	
7	Standard part	Expansion screw M12x120mm	4	
8	Tools	2.5# Hexagon socket wrench	1	
		4# Hexagon socket wrench	1	
9	User manual	A5	1	
10	Certificate	—	1	

2025-05-26 version 1

KD-2036D-4 Operation Lamp

USER MANUAL

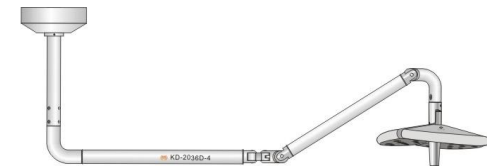

NANJING YANAN SPECIAL LIGHTING FACTORY

XIII Warranty card and maintenance card

Warranty card

Company name:			
Address		Phone No.	
Product name		Model	
Serial Number		Manufacture date	
Sale date			
Fault description:			
Remark: The warranty of our products is 18 months since release date. Please keep the certificate and instruction properly, and send it back with the product when repairing.			

(Please truthfully fill in this form, cut it according to the dotted line and send it back to our company, thank you for your cooperation)

Maintenance card

Company name:			
Address		Phone No.	
Product name		Model	
Serial Number		Manufacture date	
Sale date			
Fault description:			
Note: if you use this card beyond warranty period, you can enjoy 30% discount repair service.			

Content

I Brief introduction.....1

II Performance summary.....1

III Main technical parameters.....1

IV Security tips and symbol instructions.....2

V Working environment.....2

VI Product interface.....3

VII Usage.....3

VIII Attentions.....7

IX Failure judgment and eliminating methods.....9

X Bulb replacement.....9

XI After-sales service and warranty.....9

XII Transportation and storage condition.....10

XIII Warranty card and maintenance card.....11

XIV Configuration list.....12

I Brief introduction

KD-2036D-4 operation lamp adopts high-power brand LED as the light source, and the brightness can be adjusted in three levels: high, medium and low. The lamp head and lamp arm can rotate freely, providing multi-angle illumination. It is composed of lamp head, spring arm, center column and ceiling-mounted bracket.

The diameter of the lamp head of this product is 400mm, which is larger than the ordinary examination lamp head but smaller than the lamp panel of the shadowless lamp. Make up for small light spot, low illuminance and short lighting depth of the examination lamp. It is suitable for deep local lighting in medical aesthetics, pet medical care, outpatient departments of various departments and oral implants, etc.

II Performance summary

- 1.The product adopts a low-voltage output cold light lighting design in its design and employs a wide-voltage power supply system. Low-pressure energy-saving, stable performance, safe and reliable, and extremely long service life.
- 2.The lamp head and lamp arm of this product can rotate freely, providing multi-angle illumination. It is easy to install and operate.
- 3.The design and production of this product fully implement GB9706.1-2020 "Medical Electrical Apparatus - Part 1: Safety - General Requirements", which is guaranteed in safety.

III Main technical parameters

1. Rated voltage: AC100-240V 50Hz/60Hz
2. Input power: ≤70VA
3. Product Specification: LED-80W
4. Product color temperature: 5000K~6000K
5. Lamp head diameter: 400mm
6. Working distance: 700mm

- ◆If you modified the function by yourself and then it does not work , is not covered under warranty.
- ◆If the marks on the product such as model, serial number, date of manufacture has been altered, deleted, moved, or unidentifiable, will not provide free warranty service.
- ◆Failure caused by human factors such as falling, squeezing, soaking and damp is not covered by the warranty
- ◆The production date is shown on label, service life is 5 years, we provide lifetime maintenance.
- ◆After-sales No.:+86-25-52777091
Telephone(WeChat):+86-13675197193

XII Transportation and storage condition

Environment temperature: -40℃~55℃

Relative humidity: 30%~80%

Atmospheric pressure: 500hpa~1060hpa

IX Failure judgment and eliminating methods (This requires professional operation)

Fault phenomenon	Reason	Solution
The lamp is not on.	1.The power switch of the network is not turned on.	Turn on the power switch to supply power to the lamp.
	2.Power supply circuit is no electricity.	Check the power supply circuit of the network.
	3.Lamp switch is not turned on.	Touch the switch/brightness adjustment③ to turn on the lamp.
	4.Poor contact with plug-ins.	Reconnect the plug-ins. See Picture 4-1、 5-1.
	5.The current-limiting plate is faulty.	Replace the current-limiting plate of the same specification.
	6.Switching power supply failure.	Replace the power switch of the same specification.
	7.Other faults	Contact the service department of our company.

X Bulb replacement

The bulb of the operation lamp is LED light source, normal life is up to 10000 hours, no need to replace normally. In case of any failure, please inform the manufacturer in time for processing.

XI After-sales service

- ◆ The product warranty period is 18 months
- ◆ During warranty period, send or give us your warranty card and purchase invoices, we will provide free maintenance service when you have quality problems.
- ◆ Light bulbs are consumable accessories.

IV Security tips and symbol instructions

- 1.During the installation and use of operation lamp, to reduce the risks of fire, electric shock or personal injury, basic safety precautions and necessary protective measures should always be followed.
- 2.Read and understand all the contents of the manual and operate correctly in accordance with the requirements of the manual.
- 3.To avoid the risk of electric shock, the operation lamp must be connected to a power supply network with protective grounding and a switch must be installed via a leakage protection device.
- 4.Before cleaning the operation lamp, please disconnect the AC power supply, and do not use liquid or spray cleaners.
- 5.Do not use the operation lamp near water.
- 6.When changing the bulb, turn off the power switch first.
- 7.Please frequently check whether the fasteners of the surgical lighting fixtures are loose to prevent accidents.
- 8.The maintenance of the operation lamp should be carried out by professionals. It is recommended that operators wear electrostatic rings when working.
- 9.The brightness of the operation lamp is relatively high and it must not be directly used for eye lighting!
- 10.Graphic symbol instructions



V Working environment

Environment temperature: -5℃ ~40℃
 Relative humidity: 35%~75%
 Atmospheric pressure:700hPa~1060hPa

VI Product interface (Picture 1)

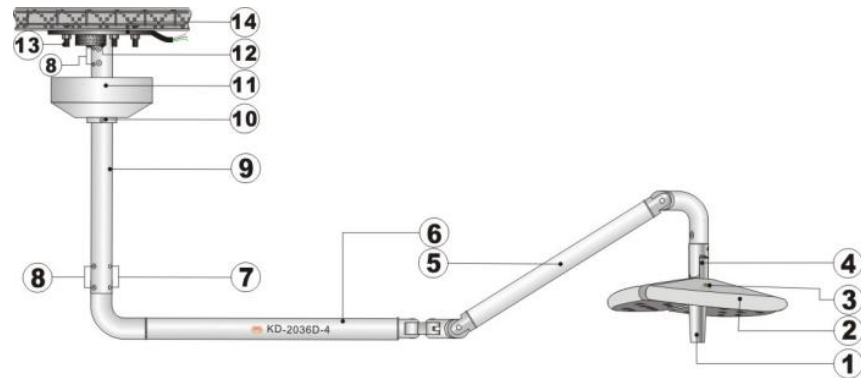

- ① Central handle ② Lamp head ③ Switch/Brightness adjustment
- ④ Steering joint ⑤ Spring arm ⑥ Horizontal arm ⑦ Damping adjustment
- ⑧ Fixed screw ⑨ Center column ⑩ Decorative cover tightening screws
- ⑪ Decorative cover ⑫ Power switch ⑬ Expansion screw ⑭ Ceiling plate

Picture 1

VII Usage

1. Check before use

- 1)Unpack and check whether the product is damaged or missing parts
- 2)According to the Configuration List, check whether the product model, name, quantity and accessories are consistent with the Configuration List;If any problem is found, please contact manufacturer in time.

3)Read the instructions carefully and follow the installation steps.

2.Product installation

- 1)Marking and drilling: According to the dimensions in Picture 2-1 or using the ceiling plate ⑭, mark out four hole positions at the appropriate locations on the roof [Note: The marking position should be at least 1800mm away from the surrounding walls as much as possible to ensure that the operation lamp can be rotated to any position.]. Drill four embedded screw holes with a depth of 110mm each at the marked positions using a ϕ 16mm drill bit, as shown in Picture 2-2. After

- 6.It is strictly prohibited to hang any items other than this equipment on the operation lamp body. Do not heavily pull or rotate the lamp head or lamp arm when in use.
- 7.Each month, use 75% alcohol cotton to remove dust on the surface of the operation lamp [Note: Please unplug the AC power plug before cleaning and prevent liquid from seeping into the lamp.].
- 8.Conduct a comprehensive inspection of nut, switch, brightness and noise of the operation lamp every quarter, timely repair and adjustment if any abnormality is found.
- 9.Bulbs are consumables and have a basic life span. The normal life of LED bulb is about 10000 hours. Pay attention to how long bulbs are used and prepare for them in advance.
- 10.The service life of the operation lamp is five years. After the expiration, if it is scrapped, its metal, electronic components, plastic, glass and other materials should be uniformly and strictly treated in accordance with local environmental protection regulations to prevent their spread or reuse, minimizing the risk of environmental pollution.

when the power switch is turned on again, the brightness is at its maximum.

5) When in use, if the lamp arm drifts due to the balance arm's rotating shaft being too loose or cannot rotate due to being too tight, a 2.5# Allen wrench can be used to adjust the tightness of the damping adjustment⑦. The adjustment should be made so that the rotation is smooth, the positioning is accurate and there is no drift.

6) Disconnect the power supply after the surgical examination is completed. When the central handle needs to be disinfected, it can be removed by rotating it counterclockwise for disinfection.

7) When not in use, use the joint between the spring arm ⑤ and the balance arm ⑥ as the fulcrum for rotation and retract the spring arm ⑤.

VIII Attentions

1. When installing the operation lamp, please assemble and reinforce them in accordance with the technical requirements stated in the manual.
2. Before cleaning the operation lamp, please disconnect the AC power supply and do not use liquid or spray cleaners. Clean the surface with a soft cloth or sponge. Do not use hard-bristled brushes or wire brushes. Also, do not apply scouring powder, paint, banana water, acid, etc. to any surface.
3. The old bulbs removed from the operation lamp should be placed in the designated waste bin.
4. The operation lamp have a relatively high illuminance. Caution should be exercised when using them for eye lighting.
5. The surface of the operation lamp should be cleaned and disinfected after the operation. [Please turn off the AC power supply and prevent liquid from seeping into the lamp before cleaning.] Neutral household detergent and antistatic agent must be used as the cleaning agent. Disinfectants based on phenolic, iodide or glutaraldehyde should not be used.

removing the debris, insert the M12*120mm expansion screw and strike it with a hammer until it is fully inserted into the embedded hole[Note: The end face of the expansion pipe is at the same horizontal level as the wall surface.], as shown in Picture 2-3. Select an appropriate wrench to tighten the nut to ensure safety and accuracy, as shown in Picture 2-4.

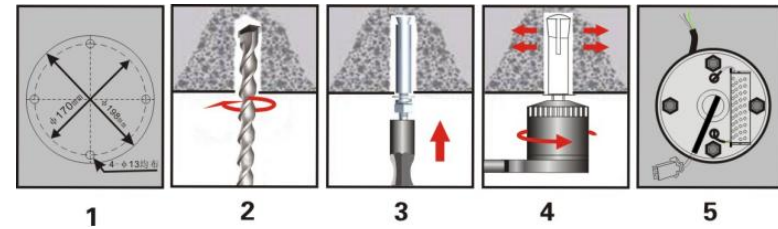

Picture 2

2) Ceiling plate installation: Align the 4 φ13 holes of the ceiling plate ⑭ with the 4 expansion screws⑬, install it on the roof, then tighten the nuts and expose the AC line outside the ceiling plate, as shown in Picture 2-5.

3) Center column installation: Straighten out the wiring, as shown in Picture 3-1. Remove the Two fixed screws⑧ between the ceiling plate and the connector the center column. Insert the decorative cover⑪ into the upper end of the center column⑨ and pass the wire through the central column, as shown in Picture 3-2. Then connect the center column⑨ with ceiling plate⑩, install the fixed screws⑧, do not tighten them yet. After both screws are installed, tighten them separately as shown in Picture 3-3.

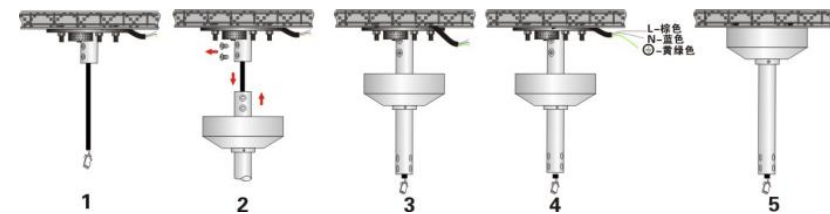

Picture 3

4) AC power connection: Before connecting the AC power supply, the user needs to confirm that the AC power supply is provided by installing a switch on the leakage protection device. Turn off the switch. Connect the brown wire, blue wire and yellowish-green wire to the L phase wire, N phase wire and ground wire respectively as shown in Picture 3-4, and wrap them firmly with insulating tape. Then push the decorative cover ⑪ into place and tighten the decorative cover screws ⑩, as shown in Picture 3-5.

5) Spring arm and horizontal arm installation: Remove the 2 fixed screws ⑧ on the horizontal arm ⑥. Connect the connection plug as shown in Picture 4-1 firmly. Then connect the horizontal arm ⑥ with the center column ⑨. Install the fixed screws ⑧. Do not tighten them yet. After both screws are installed, tighten them separately as shown in Picture 4-2、3.

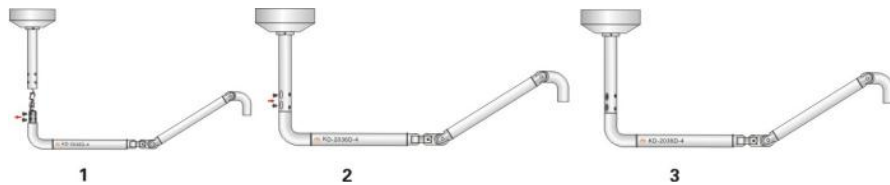

Picture 4

6) Lamp head installation: Remove the hexagonal head screws on the connector of the lamp head, firmly connect the connection plug as shown in Picture 5-1. Connect the lamp head ② with the spring arm ⑤, install the M5 fixed screw and tighten it as shown in Picture 5-2、3. Then rotate the central handle ① in the direction indicated by the arrow and install it onto the base as shown in Picture 5-3, 4. The product installation is completed.

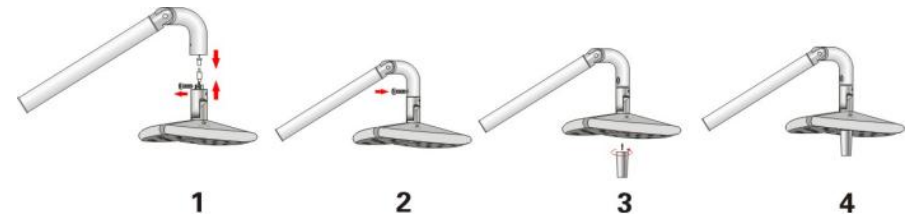

Picture 5

3.Usage

- 1) Connect the power supply to the network, and the operation lamp will light up and start working.
- 2) By holding the central handle ①, the height and Angle of the lamp head can be adjusted up and down. Alternatively, a 90° rotation adjustment can be made through the vertical gap of the steering joint ④, as indicated by the arrow in Picture 6-1. Do not turn in the direction indicated by the arrows in Picture 6-2, as it may cause joint damage and render the operation lamp unusable.

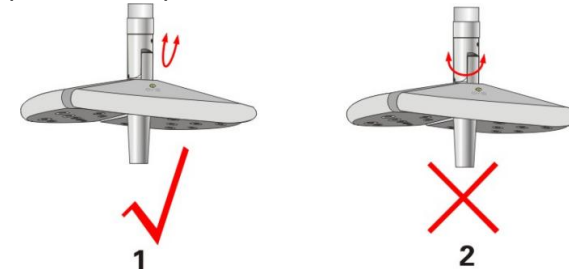

Picture 6

- 3) This product can be horizontally adjusted left and right with the joint between the spring arm ⑤ and the balance arm ⑥ as the fulcrum. It can also be circumferentially adjusted by the rotating shaft at the connection between the balance arm and the middle column to change the direction and Angle of the lighting, achieving lighting at any position.
- 4) The operation lamp has three brightness adjustment levels. When it is turned on, the brightness is at its maximum. Each time the switch/brightness adjustment is touched, the brightness of the operation lamp will decrease by one level until the lamp is turned off. In any state,